

**VERMONT - FRANKFORT INDUSTRIAL**  
FRANKFORT, ILLINOIS

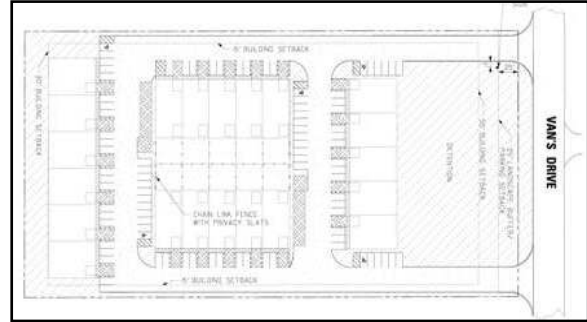

Engineering Services were provided for the development of an industrial / warehouse facility on approximately 4.7 acres. Site improvements included stormwater management facilities, sanitary sewer, water main, parking, detailed site grading and soil erosion and sedimentation control measures. Coordination with the Village of Frankfort and other agencies for the necessary permits was included.

**Service Provided:**

- Prepared Preliminary and Final Site Engineering Plans and the appropriate construction documents
- Provided Topographic and Boundary Survey
- Provided Preliminary Geotechnical Investigation report
- Provided agency coordination

This project reflects Firm  
and Staff experience.



Excellence, Service, Integrity  
www.esild.com